

# INVITATION TO BID 6801 OF

## ATTACHMENT B

PROJECT NO. \_\_\_\_\_ SHEET NO. **6801A**  
C.A.

**OCTAGON**

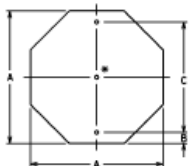

A	B	C	ALUM	SO FT
18	2	14	.063	1.9
30	3	24	.080	5.2
36	3	30	.100	7.5

\* CENTER MOUNTING HOLE REQUIRED

**48" OCTAGON**

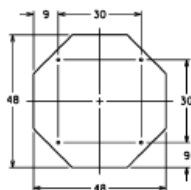

ALUM	SO FT
.100	13.3

**EQUILATERAL TRIANGLE**

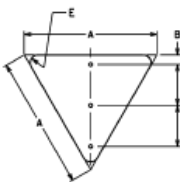

A	B	C	D	E	ALUM	SO FT
36	3	10	11	2	.080	3.9
42	3	13	13	2 1/2	.100	5.3

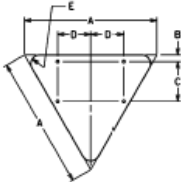

A	B	C	D	E	ALUM	SO FT
48	3	12	12	3	.100	6.9
60	3	18	15	4	.100	10.8

**18" OBJECT MARKER**

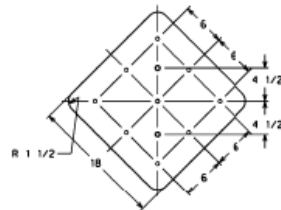

Ø DIA	Ø DIA	ALUM	SO FT
.193	5/16 DR 3/8	.063	2.3

.193 - No. DRILL 11

**SQUARE & DIAMOND**

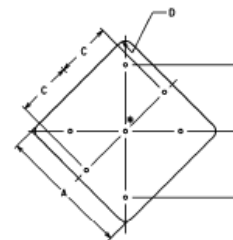

A	B	C	D	ALUM	SO FT
12	-	4	1 1/2	.063	1.0
18	9	6	1 1/2	.063	2.3
24	12	9	1 1/2	.080	4.0
30	15	12	1 7/8	.080	6.3
36	18	15	2 1/4	.100	9.0

\* CENTER MOUNTING HOLE REQUIRED

**48" SQUARE & DIAMOND**

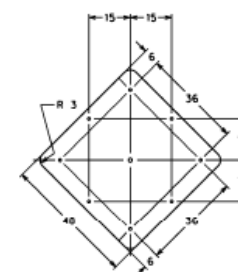

ALUM	SO FT
.080	16.0
.100	16.0

9 MOUNTING HOLES REQUIRED

**VERTICAL & HORIZONTAL RECTANGLE, SINGLE POST**

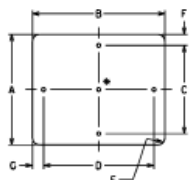

A	B	C	D	E	F	G	ALUM	SO FT
10	24	7	18	1 1/2	1 1/2	3	.080	1.7
12	24	9	18	1 1/2	1 1/2	3	.080	2.0
12	36	9	30	1 1/2	1 1/2	3	.080	3.0
18	24	12	18	1 1/2	3	3	.080	3.0
18	36	12	30	1 1/2	3	3	.080	4.5
24	30	18	24	1 1/2	3	3	.080	5.0
24	36	18	30	1 1/2	3	3	.080	6.0
24	42	18	36	1 1/2	3	3	.080	7.0
30	36	24	30	1 7/8	3	3	.080	7.5

\* CENTER MOUNTING HOLE REQUIRED

**21" X 15" RECTANGLE**

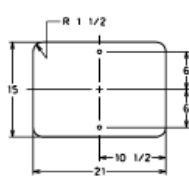

ALUM	SO FT
.063	2.2

**ISOSCELES TRIANGLE**

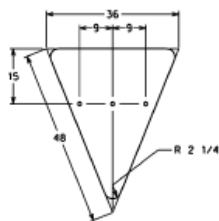

ALUM	SO FT
.100	5.6

**PENTAGON (SCHOOL)**

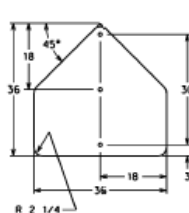

ALUM	SO FT
.100	6.8

CENTER MOUNTING HOLE REQUIRED

**INTERSTATE SHIELD**

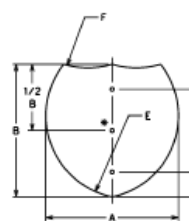

A	B	C	D	E	F	ALUM	SO FT	
24	24	3	18	15	15	.080	3.8	
30	24	3	18	17	24	.080	5.7	
36	36	6	24	22	22	1/2	.100	8.5
45	36	6	24	25	1/2	36	.100	10.5
48	48	9	30	30	30	.100	12.9	
60	48	9	30	34	48	.100	16.1	

\* CENTER MOUNTING HOLE REQUIRED

**FEDERAL SHIELD**

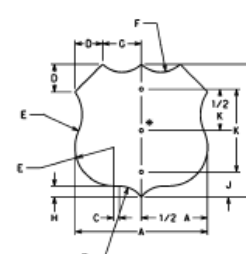

A	B	C	D	E	F	G
24	24	1	5	7	5	7
30	24	4	5	7	9	10
36	36	1 1/2	7 1/2	10 1/2	1 1/2	10 1/2
45	36	5 1/2	7 1/2	10 1/2	13 1/2	15
48	48	2	10	14	10	14
60	48	8	10	14	18	18

**CIRCLE**

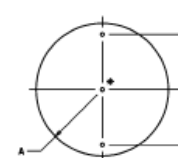

A	B	ALUM	SO FT
15	12	.080	4.9
18	15	.100	7.1

\* CENTER MOUNTING HOLE REQUIRED

**VERTICAL & HORIZONTAL RECTANGLE, DOUBLE POST**

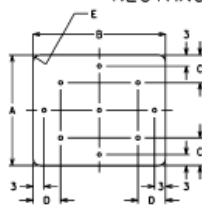

A	B	C	D	E	ALUM	SO FT
18	48	3	9	1 1/2	.100	6.0
24	48	3	9	1 7/8	.100	8.0
30	48	3	9	1 7/8	.100	10.0
36	48	6	9	2 1/4	.100	12.0
18	54	3	9	1 1/2	.100	6.8
24	54	3	9	1 7/8	.100	9.0
24	60	3	12	1 7/8	.125	10.0
30	60	3	12	1 7/8	.125	12.5
36	60	6	12	2 1/4	.125	15.0
48	60	9	12	3	.125	20.0

9 MOUNTING HOLES REQUIRED

### NOTES

- ALL DIMENSIONS ARE IN INCHES.
- ALL BLANKS ARE SYMMETRICAL ABOUT CENTERLINES.
- HOLE SIZES ARE 3/8" DIA, UNLESS OTHERWISE SPECIFIED.



NEBRASKA DEPARTMENT OF ROADS TRAFFIC ENGINEERING DIVISION			
TYPICAL SIGN INSTALLATION			
DESIGNED	DESIGN DETAILS		
REVIEWED	BLANK STANDARDS & HOLE LOCATIONS		
APPROVED	DATE DRAWN	TRAFFIC ENGINEER	DATE
	8/14		

TRAFFIC ENGINEERING DIVISION  
Computer: D:\TRAFFIC\B  
User: dpr2102  
Date: 21-JUL-2016 09:38  
File: vtbltbl11b.dgn  
Scale: 1/8"=1'-0"